

DOORSENSE

8755A DoorSense User Guide plus Maintenance Test Record

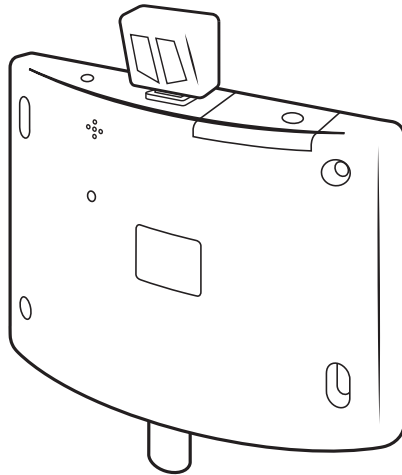

UNION recommend that you read this guide to installing, using and maintaining DoorSense before beginning any work, and that it is kept in a safe place for future use.

English Version 3.0

Trusted by **Professionals**



ASSA ABLOY

ASSA ABLOY, the global leader
in door opening solutions



Contents



What is DoorSense?	page 3
What's included with DoorSense	page 3
Before you begin...	page 4
Preparing DoorSense for installation	page 5
Installing DoorSense	page 7
Using DoorSense	page 9
DoorSense alerts	page 11
Maintaining DoorSense	page 13
Battery maintenance record	page 13
DoorSense maintenance record	page 14
DoorSense installation record	page 18

CE Marked to EN 1155, the DoP number 0121DCD is available to view or download at www.uniononline.co.uk/DoP

What is DoorSense?



DoorSense is a standalone, battery-powered unit which can be fixed to a door in seconds to provide a reliable way to keep it open, and automatically release it if the fire alarm sounds. DoorSense is designed to react to a continuous sound of over 65dB when heard for at least 15 seconds.

DoorSense is incredibly easy to install, needing no wiring or specialist skills - just

use the fixing template provided. DoorSense can even be retrofitted to doors using older door release mechanisms.

Once installed you can activate DoorSense working manually, using either the foot release or gently pushing the door open wider or automatically using the pre-set timer release.

What's included with DoorSense

2 x C-Type batteries

Adjuster tool

Floorplate with stop

Floorplate without stop

Floor plate screw pack
4 x black screws
4 x plugs for concrete floors

Unit screw pack
4 x silver screws

Tools needed to install

- Screwdriver
- Pen/pencil
- 6mm drill bit (To suit floor type)
- 1.5mm drill bit (To suit door type)

Before you begin...



Please check the following...

- 1** Ensure the door has been fitted with a door closer which is working correctly (UNION have an extensive range of door closers which are ideal for almost any application)
- 2** The floor underneath the sweep of the door as it opens is level
- 3** The gap between the bottom of the door and the floor is no less than 5mm (3/16") so the door can swing over the floor plate
- 4** The door opens to an angle of more than 65°
- 5** The building has a fire alarm system installed which is clearly audible where the door is fitted

Preparing DoorSense for installation



DoorSense can be used 24/7, which makes it perfect for continuous traffic applications.

If DoorSense is being fitted to doors in a building that has periods of no or low usage, UNION recommend using the time release to help prevent spread of fire.

DoorSense contains an internal clock which governs the release timer and the self-testing features.

The clock is powered by the batteries and resets when they are removed.

All clock timings are based on 12:00pm (noon) which is why any replacement of batteries used in a DoorSense unit should be undertaken at that time. If this does not suit your situation, you should calculate any timing differences between the DoorSense clock time and real time before adjusting the timer release settings.

- The clock retains a small amount of power when the batteries are removed. To ensure the clock resets properly, wait 10 seconds between releasing and re-fastening battery compartment.

1 Check to make sure you have the following:

- DoorSense unit
- Floorplate with stop
- Floorplate without stop
- 2 x C-type batteries
- Fasteners for fixing DoorSense and the floorplate
- An installation template
- Alarm sensitivity adjustment tool

2 Set The Optional Release Timer

Turn the unit over to view the timer settings on the rear.

Using the supplied tool, move switches to the desired setting shown opposite.

NOTE:

Switch 3 silences the timer release warning tone.

Switch 4 is not used for the timer release function.

3 Insert batteries

DoorSense uses 2 x C-Type alkaline batteries. Do not use rechargeable batteries.

TIP: If you want to use the release timer, insert the batteries at 12:00pm (noon) to match the internal clock to real time.

3A Fully slacken the screw holding the battery compartment cover with a screwdriver and lift up from DoorSense unit.

NOTE: the screw will not detach from compartment.

3B Insert both batteries against the slider of the battery compartment, in the sequence shown on the battery slide.

3C Push the filled battery compartment back into DoorSense unit body and fasten retaining screw.

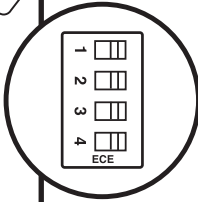
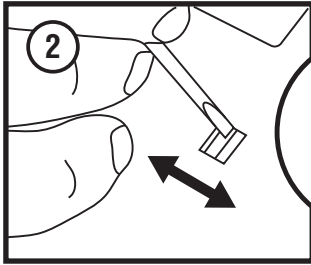

Key:

Solid Light	Slow flash	Fast flash	Green Light	Yellow Light	Red Light

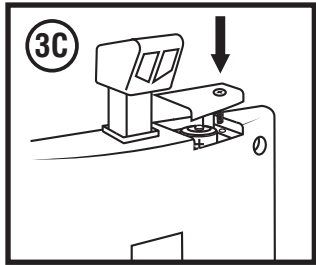
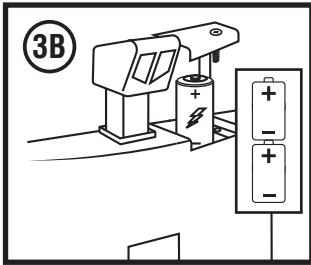
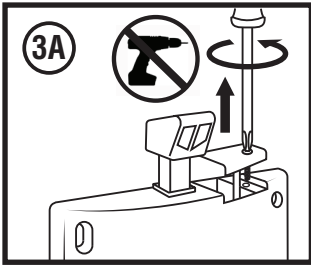

1	2	3	4
Switch on	None		
Release	N/A		
Re set	N/A		
Warning sound	N/A		
Alert			
	Slow flash 10 secs		

1	2	3	4
Switch on	1 only		
Release	8pm		
Re set	8am		
Warning sound	Yes		
Alert			
	1 flash		

1	2	3	4
Switch on	2 only		
Release	9pm		
Re set	7am		
Warning sound	Yes		
Alert			
	2 flashes		

1	2	3	4
Switch on	3 only		
Release	N/A		
Re set	N/A		
Warning sound	No		
Alert			
	3 flashes		

1	2	3	4
Switch on	1,2		
Release	10pm		
Re set	6am		
Warning sound	Yes		
Alert	+		
	1 flash 2 flashes		

1	2	3	4
Switch on	1,3		
Release	8pm		
Re set	8am		
Warning sound	No		
Alert	+		
	1 flash 3 flashes		

1	2	3	4
Switch on	2,3		
Release	9pm		
Re set	7am		
Warning sound	No		
Alert	+		
	2 flashes 3 flashes		

1	2	3	4
Switch on	1,2,3		
Release	10pm		
Re set	6am		
Warning sound	No		
Alert	+ +		
	1 flash 2 flashes 3 flashes		

Installing DoorSense





- DoorSense can be installed on single or double doors
- Always fit DoorSense at the lock edge of a door
- We recommend you check batteries are inserted before fitting DoorSense to a door
- Check the timer release is set correctly
- Check you are on the side of door which rests against frame, with the fixing template the correct way round to suit the door, positioned at the lock edge of the door and NOT against the hinged side.



- 5 When you are satisfied that DoorSense is positioned correctly, place the remaining 2 screws into the round fixing holes and tighten up all 4 screws to secure the unit in place.
- 6 When your DoorSense unit is working correctly, the LED light on the top of the unit will flash green once every 32 seconds.
 - If the unit hears a sound between 65Db and 80Db, the flash frequency increases to once every 1.3 seconds.
 - Long tone indicates start of power up test.

Body







- 1 Put the fixing template on the door face so it rests against frame stop and bottom edge of door
 - Make sure the arrows on the template point to lock side of the door frame and bottom edge of door. If they do not, turn the template over
- 2 Mark the fixing positions and remove the template from the door
- 3 Drill the holes using a size 1.5mm drill bit to a depth of 25mm
- 4 Offer up DoorSense to the door and gently fix the unit through the two slotted holes diagonally opposite each other.
 - Open and close the door to check it can still swing easily when DoorSense is not being used
 - To get the correct height position for DoorSense, the plunger should contact the floor when pushed down
 - If the plunger is not in contact with the floor when pushed down, or it cannot be pushed down fully, adjust the unit up or down using the free space within the slots until you find the correct position.



DoorSense Alert		
	4 secs	15 secs
What this means	DoorSense is beginning power up test.	
What you need to do	Nothing.	

DoorSense Alert		32 secs		repeat
	1 flash		1 flash	
What this means	DoorSense is working OK and is "listening" for an alarm.			
What you need to do	Nothing.			

Key:

					
Solid Light	Slow flash	Fast flash	Green Light	Yellow Light	Red Light

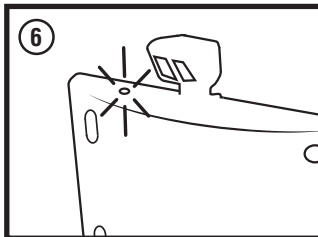
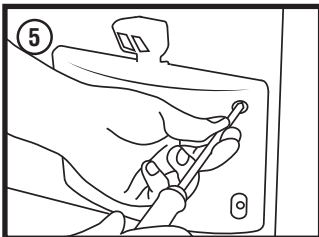
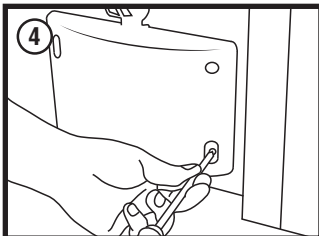
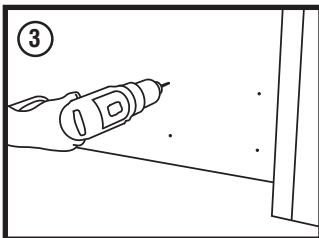
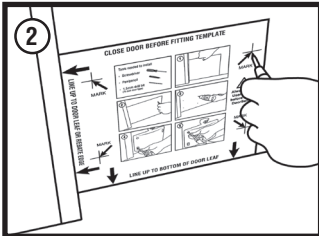
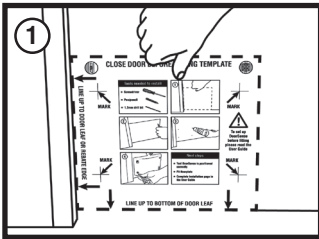

Floorplate

The floorplate is essential to ensure DoorSense works correctly. It is fixed to the floor and, when fitted correctly, will retain the stopper, thus holding the door open.

- ALWAYS install the floorplate to ensure DoorSense works correctly
- There are two floorplates you can use:
 - A floorplate with door stop to protect walls from door hardware
 - A flat footplate without stop for use in open spaces
- Before fixing floorplate, check for pipes, cables to prevent accidental damage
- With the foot pedal in the raised position, open the door to an angle of at least 65°
- Slide the floorplate under the door and push down on the foot pedal
- Check the stopper locates into the recess of the floorplate
- Mark position of floorplate screw holes on floor surface
- Release foot pedal, allow door to close and remove foot plate
- Fix floorplate in place using screws provided. Take care to use a suitable drill bit for the floor.

Using DoorSense



To hold door open

- 1 Open door to cover floorplate
- 2 Press foot pedal down
- 3 See stopper locate into floorplate dimple
- 4 Take foot off foot pedal

To release door

- 1 Gently tap foot pedal towards the door face
OR
- 2 Gently push door further open (if room to do so).

Programmed test releases

- o DoorSense will automatically release the foot pedal 12 hours after batteries are inserted (resetting the clock) and then again every 7 days
- o If in hold open mode, releasing the foot pedal will cause door to shut
- o If a fault is found, a warning tone sounds and DoorSense goes into fail safe mode (foot pedal won't stay pressed down so door can't be held open).

Sound driven release

- 1 Open door as described above
- 2 Let fire alarm sound for 30 seconds
- 3 Look for a single green flash every 1.3 seconds – this indicates DoorSense has “heard” the alarm





- 4 DoorSense will release the foot pedal within 20 seconds allowing door to close
- 5 Listen for a warning tone then a fast flash green light for 20 seconds before releasing door





- 6 DoorSense will take 10 seconds to re-set itself and be ready to hold door open again









- 7 UNION recommend conducting weekly alarm driven tests of your DoorSense.

DoorSense Alert		 slow flash 20 secs
What this means	DoorSense is going to release the foot pedal to allow the door to close. NB if warning tones are already switched off there will be no beeps, just the warning light flashes.	
What you need to do	Nothing to DoorSense but check door way is clear so door can shut and door closer is still operating correctly.	

DoorSense Alert		 10 secs	Followed by the motor sound
What this means	DoorSense unit is re-setting after release so it can hold the door open again.		
What you need to do	Nothing.		

Key:

					
Solid Light	Slow flash	Fast flash	Green Light	Yellow Light	Red Light

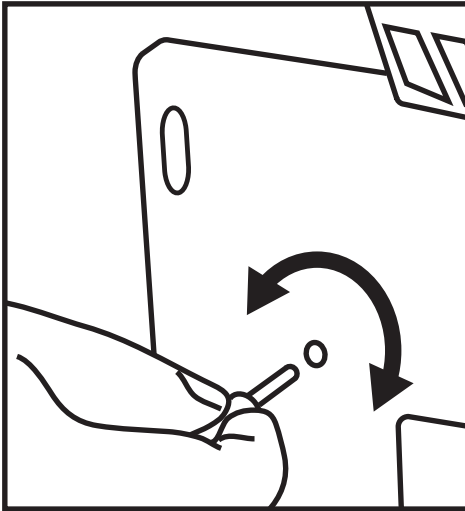

- **Altering your DoorSense sensitivity**

- You may need to adjust the sensitivity of your DoorSense to suit the location
- Only use the plastic tool provided to make adjustments

1 Push plastic tool into hole on front of DoorSense body

2 Carefully turn the tool a few degrees

- Clockwise to increase sensitivity and help DoorSense react to sounds
- Anti-clockwise to decrease sensitivity and reduce DoorSense reacting to sounds

3 Check DoorSense responds to fire alarm (as per instructions above)



4 If not, repeat previous steps.

NOTE: The adjustment has a minimum and maximum setting which you will feel as a resistance against turning further. Do not try to turn the adjustment beyond this point.

DoorSense alerts





DoorSense Alert

 32 secs  repeat
1 flash 1 flash

What this means
DoorSense is working OK and is "listening" for an alarm.

What you need to do
Nothing.



DoorSense Alert

  slow flash
20 secs

What this means
DoorSense is going to release the foot pedal to allow the door to close. NB if warning tones are already switched off there will be no beeps, just the warning light flashes.

What you need to do
Nothing to DoorSense but check door way is clear so door can shut and door closer is still operating correctly.



DoorSense Alert

  15 secs
Followed by the motor sound

What this means
DoorSense unit is re-setting after release so it can hold the door open again.

What you need to do
Nothing.

DoorSense Alert

  40 secs
As batteries drain this changes to a fast red flash for 60secs

What this means
DoorSense batteries are running low and should be replaced.

What you need to do

- 1) Open battery compartment
- 2) Remove old batteries and discard
- 3) Insert new batteries
- 4) Fasten battery compartment

See "Maintaining DoorSense"

Key:

 Sound alert to attract attention to LED

 Solid Light

 Slow flash

 Fast flash

 Green Light

 Yellow Light

 Red Light

DoorSense alerts

DoorSense Alert



5 secs

What this means DoorSense battery compartment is not shut properly.

What you need to do Undo battery compartment screw then re-tighten, see "Preparing your DoorSense".

DoorSense Alert



60 secs **fast flash**

What this means DoorSense motor is not working – possible fault.

What you need to do

- 1) Check DoorSense is fitted flat to the door face
- 2) Check battery power and replace if low
- 3) Check stopper is not worn – if it is, replace DoorSense

DoorSense Alert



30 secs **slow flash**

What this means DoorSense foot pedal movement concern.

What you need to do

- 1) Check DoorSense is fitted flat to the doorface
- 2) Check battery power and replace if low
- 3) Check stopper is not worn – if it is, replace DoorSense

DoorSense Alert



4 secs



15 secs

What this means DoorSense is beginning power up test.

What you need to do Nothing.

DoorSense Alert



10 secs **slow flash**

What this means No dip switch has been selected.

What you need to do Set dip switch as required.

DoorSense Alert



60 secs **1 flash**

What this means Night time mode.

What you need to do Nothing.

Maintaining DoorSense



Looking after your DoorSense unit will help it to work longer.

Here are some simple maintenance tasks to undertake on weekly, monthly and annually.

To help you plan these maintenance check, please use the DoorSense Maintenance Records pages in this User Guide.

Weekly

- Checks should be done to ensure the DoorSense unit continues to hold the door open, hear and react to the fire alarm sounding for at least 20 seconds
- If the DoorSense does not work as expected, please go to DoorSense Alerts section

Monthly

- Once a month, also check that the microphone holes on curved face of DoorSense units are free from dirt and debris
- A gentle wipe with a damp cloth will help keep the microphone clear and the unit looking clean
- UNION recommend regularly checking the DoorSense unit and floor plates are damage free and remain securely screwed to door and floor
- If there is any damage, consider replacing your DoorSense

Annually

- Replace the batteries once a year or when the low battery alarm sounds (see page 11), whichever happens first.

Battery maintenance schedule

DoorSense uses 2 x C-Type alkaline batteries. **Do not** use rechargeable batteries. Record your battery replacement dates in the table below.

No	Date
1	
2	
3	
4	
5	
6	
7	
8	
9	
10	

No	Date
11	
12	
13	
14	
15	
16	
17	
18	
19	
20	

DoorSense maintenance record



UNION recommends you inspect any installation of DoorSense at least annually.

Keep a record of your DoorSense inspections below.

Inspection Date	
Unit Condition	
Inspected by	
Signed	

Inspection Date	
Unit Condition	
Inspected by	
Signed	

DoorSense maintenance record



Inspection Date	
Unit Condition	
Inspected by	
Signed	

Inspection Date	
Unit Condition	
Inspected by	
Signed	

Inspection Date	
Unit Condition	
Inspected by	
Signed	

DoorSense maintenance record



Inspection Date	
Unit Condition	
Inspected by	
Signed	

Inspection Date	
Unit Condition	
Inspected by	
Signed	

Inspection Date	
Unit Condition	
Inspected by	
Signed	

DoorSense maintenance record



Inspection Date	
Unit Condition	
Inspected by	
Signed	

Inspection Date	
Unit Condition	
Inspected by	
Signed	

Inspection Date	
Unit Condition	
Inspected by	
Signed	

DoorSense installation record



Insert the details of your DoorSense installation below.

Company Name	
Installation Date	
Door Location	
Building Address	
Installer Name	
Company	
Address	
Telephone	

**For further details on this or any of
the products in the UNION range please contact your
Regional Sales Manager or the Customer Services Department:**

ASSA ABLOY Security Solutions
School Street, Willenhall WV13 3PW
Tel: 0845 223 2124 Email: info@uniononline.co.uk
www.uniononline.co.uk

Version 3.0



ASSA ABLOY

Trusted by **Professionals**

ASSA ABLOY, the global leader
in door opening solutions